



Estd. 1910

E. E. Karachiwala & Co.

43/45 Narayan Rao Koli Marg, Masjid Bunder Stn (W), Mumbai 400003.

t: +91-22-23444586 / 23421617 / 23450667 / 23429167

e: sales@eekarachiwala.com | www.eekarachiwala.com

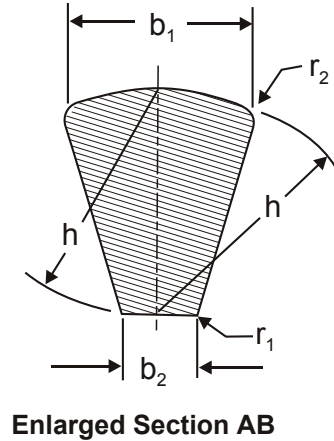
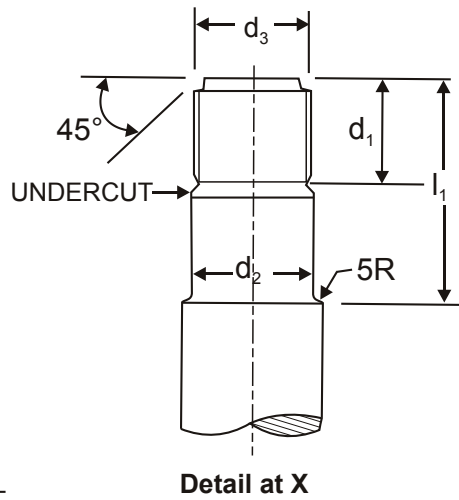
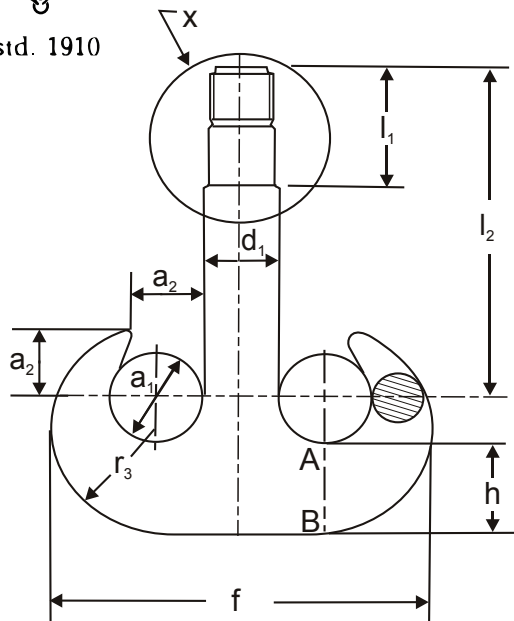

Dimensions of screw thread run outs and undercuts.

Rating W (tons)	40	50	63	80	100	125	160	200	250
Proof load P (tons)	70	85	100	120	145	170	215	266	333
$a_1(28/P)$	125±4	140±4	160±5	180±5	200±6	224±7	250±8	280±9	315±10
$a_2(0.8 a_1)$	100±3	112±3	125±4	140±4	160±5	180±5	200±6	224±7	250±8
$b_1(0.85 a_1)$	100+11 0	118+12 0	132+14 0	150+16 0	170+18 0	190+20 0	212+22 0	236+25 0	265+28 0
$b_2(0.335 a_1)$	43+5 0	48+5 0	53+6 0	60+6 0	7+7 0	75+8 0	85+9 0	95+10 0	106+11 0
$d_1(0.85 a_1)$	106±5	118±6	132±7	150±8	170±9	190±10	212±11	236±12	265±13
$d_2(0.71 a_1)$	90	100	110	125	140	160	180	200	225
d_3	M90 x 6	M100 x 6	M110 x 6	M125 x 6	M140 x 6	M160 x 6	M180 x 6	M200 x 6	M225 x 6
$f(4.25 a_1)$	530	600	670	750	850	950	1060	1180	1320
$h(1.06 a_1)$	132+13 0	150+15 0	170+17 0	190+19 0	212+21 0	236+24 0	265+27 0	300+30 0	335+34 0
l_1	188	207	234	260	282	325	357	305	455
$l_2^\#$	510	572	645	705	790	896	1005	1130	1260
m, Min	80	90	100	112	125	140	160	180	200
$r_1(0.125 a_1)$	16	18	20	22	25	28	32	36	40
$r_2(0.1 a_1)$	13	14	16	18	20	22	25	28	32
$r_3(1.18 a_1)$	150	170	190	212	236	265	300	335	375

All Dimension in millimeters

NOTE : Undercut according to IS : 1369-1961.

Equivalent knuckle or round threads are permissible.

A different length may be specified subject to agreement between the supplier and the purchaser.